



KAB terminal block label



Product information

KAB - for terminal manufacturers Allen Bradley, ABB Entelec, Lütze, Woertz and Weidmüller (WDU, WPU).

High-quality, halogen-free snap-in label plates. Labels available for mounting individually or in strips.

The large printable area at the top allows room for individual project and terminal block reference, without the need for additional organizational systems.

Information, conformities and approvals

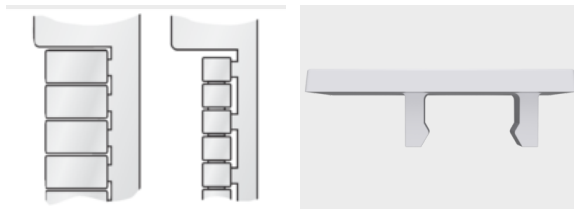

Article	Order No.	Color	RAL similar	Label size * mm	Printable area* mm	Number of characters / lines	Quantity per frame	Base plate	Software Article	PU pcs.
Single labels										
KAB 6/12	86402014	White	9016	6 x 12	6 x 12	6 / 1	72	GP4	112	1008
5 mm pitch strips in a row										
KAB 5/5.4-5	86402004	White	9016	5 x 5.4	5 x 5.4	3 / 1	110	GP5 Single tree adapter 5	55	1430
KAB 5/9-5	86402006	White	9016	5 x 9	5 x 9	5 / 1	88	GP4	110	1408
KAB 5/12-5	86402008	White	9016	5 x 12	5 x 12	6 / 1	88	GP4	111	1408
6 mm pitch strips in a row										
KAB 6/9-6	86402010	White	9016	6 x 9	6 x 9	5 / 1	72	GP4	50	1008
KAB 6/10-6	86402022	White	9016	6 x 10	6 x 10	5 / 1	72	GP4	56	1008
KAB 6/12-6	86402012	White	9016	6 x 12	6 x 12	6 / 1	72	GP4	51	1008
8 mm pitch strips in a row										
KAB 8/9-8	86402016	White	9016	8 x 9	8 x 9	5 / 2	52	GP4	53	1040
KAB 8/12-8	86402018	White	9016	8 x 12	8 x 12	6 / 2	52	GP4	54	1040



KAB terminal block label

Material properties



Polycarbonate (PC)

Thermal properties



Temperature / temperature range

-40 °C - 130 °C

Fire properties



Fire classification

V0

Technical information



Halogen-free

Classification

ETIM 9: EC000761
ECLASS 14: 27281101
UNSPSC 26.0801: 39131504

General technical data



Assembly method

0000000011000

Assembly method



Snap-fit system



Strip system

Labelling technology



Plotter



Laser



KAB terminal block label

Labelling technology



Inkjet
