



Cable entry plate plastic type KDP/N 24



Product information

- Snap-in plastic cable entry plate with two elastomer plates
- Economical connection technology for tool-free wiring of equipment and machinery
- The alternative to cable fittings
- Very good strain relief
- Protection class: IP 65
- Thermal stability: -30 °C to +70 °C
- Material: Frame: Polyamide 6.6 / Seal: TPU/NBR/EPDM
- RoHS Compliant
- UV-resistant
- Made in Germany
- Suitable for standard cut-outs for 24-pin industrial connectors
- Assembly possible with catch hooks (sheet thickness 1.5 mm - 2.0 mm) or with M5 screws

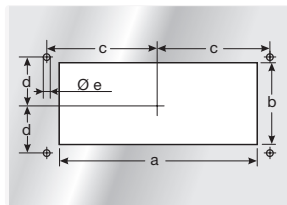
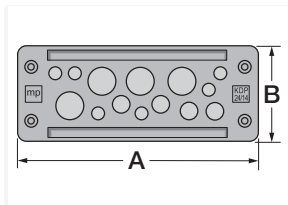

Information, conformities and approvals



| Article | Order No. | Color | No. of openings | Openings number/Ø | Cut-out | PU pcs. |
|---------------------|-----------|-------|-----------------|---|---------|---------|
| KDP/N 24/10 | 87301108 | Black | 10 | 2x 3 mm - 6.5 mm 1x 5 mm - 9.2 mm 5x 9 mm - 14 mm 2x 14 mm - 20 mm | 24-pole | 1 |
| KDP/N 24/11 | 87301110 | Black | 11 | 4x 3 mm - 6.5 mm 4x 5 mm - 9.2 mm 3x 14 mm - 20 mm | 24-pole | 1 |
| KDP/N 24/12 | 87301120 | Black | 12 | 12x 8 mm - 12 mm | 24-pole | 1 |
| KDP/N 24/13 | 87301130 | Black | 13 | 2x 3 mm - 5.5 mm 6x 4.1 mm - 8.1 mm 4x 9 mm - 14 mm 1x 14 mm - 20 mm | 24-pole | 1 |
| KDP/N 24/14 | 87301140 | Black | 14 | 6x 3 mm - 6.5 mm 4x 5 mm - 9.2 mm 4x 9.6 mm - 15.9 mm | 24-pole | 1 |
| KDP/N 24/17 | 87301150 | Black | 17 | 17x 5 mm - 9.2 mm | 24-pole | 1 |
| KDP/N 24/17-1 | 87301151 | Black | 17 | 11x 3 mm - 6.5 mm 1x 4.1 mm - 8.1 mm 5x 8 mm - 12.5 mm | 24-pole | 1 |
| KDP/N 24/22 | 87301160 | Black | 22 | 16x 3 mm - 6.5 mm 4x 5 mm - 9.2 mm 2x 8 mm - 12.5 mm | 24-pole | 1 |
| KDP/N 24/22, PU 100 | 87301161 | Black | 22 | 16x 3 mm - 6.5 mm 4x 5 mm - 9.2 mm 2x 8 mm - 12.5 mm | 24-pole | 100 |



Cable entry plate plastic type KDP/N 24

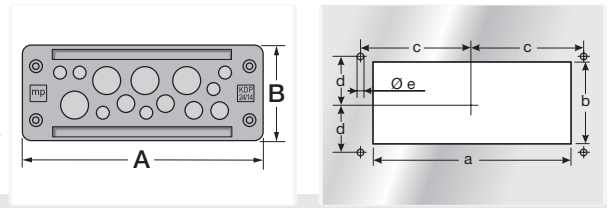

| Article | Order No. | Color | No. of openings | Openings number/Ø | Cut-out | PU pcs. |
|---------------------------|-----------|-------|-----------------|---|---------|---------|
| KDP/N 24/23 | 87301170 | Black | 23 | 23x 4.1 mm - 8.1 mm | 24-pole | 1 |
| KDP/N 24/29 | 87301180 | Black | 29 | 29x 3 mm - 6.5 mm | 24-pole | 1 |
| KDP/N 24/29, open, VE 100 | 87301182 | Black | 29 | 29x 3 mm - 6.5 mm | 24-pole | 100 |
| KDP/N 24/80 | 87301190 | Black | 80 | 78x 1.5 mm - 2.6 mm 2x 2.5 mm - 5 mm | 24-pole | 1 |

Cable entry plate KDP rectangular dimension table

| Article | Order No. | Installation height mm | A mm | B mm | a mm | b mm | c mm | d mm | e mm |
|---------------------------|-----------|------------------------|------|------|------|------|------|------|------|
| KDP/N 24/10 | 87301108 | 15 | 148 | 60 | 112 | 36 | 65 | 16 | 5.5 |
| KDP/N 24/11 | 87301110 | 15 | 148 | 60 | 112 | 36 | 65 | 16 | 5.5 |
| KDP/N 24/12 | 87301120 | 15 | 148 | 60 | 112 | 36 | 65 | 16 | 5.5 |
| KDP/N 24/13 | 87301130 | 15 | 148 | 60 | 112 | 36 | 65 | 16 | 5.5 |
| KDP/N 24/14 | 87301140 | 15 | 148 | 60 | 112 | 36 | 65 | 16 | 5.5 |
| KDP/N 24/17 | 87301150 | 15 | 148 | 60 | 112 | 36 | 65 | 16 | 5.5 |
| KDP/N 24/17-1 | 87301151 | 15 | 148 | 60 | 112 | 36 | 65 | 16 | 5.5 |
| KDP/N 24/22 | 87301160 | 15 | 148 | 60 | 112 | 36 | 65 | 16 | 5.5 |
| KDP/N 24/22, PU 100 | 87301161 | 15 | 148 | 60 | 112 | 36 | 65 | 16 | 5.5 |
| KDP/N 24/23 | 87301170 | 15 | 148 | 60 | 112 | 36 | 65 | 16 | 5.5 |
| KDP/N 24/29 | 87301180 | 15 | 148 | 60 | 112 | 36 | 65 | 16 | 5.5 |
| KDP/N 24/29, open, VE 100 | 87301182 | 15 | 148 | 60 | 112 | 36 | 65 | 16 | 5.5 |
| KDP/N 24/80 | 87301190 | 15 | 148 | 60 | 112 | 36 | 65 | 16 | 5.5 |

Material properties



Polyamide 6.6 | TPU / NBR / EPDM |



Cable entry plate plastic type KDP/N 24

Thermal properties



Temperature / temperature range -30 °C – 70 °C

Protection class



Protection class IP65

Fire properties



Fire classification V0, HB Frame; Block:

Technical information



LABS free



According to EN -2-1

Conformity



RoHS (EC Directive 2011/65/EU)

Approvals and operating permits



GL approval



UL type 12

General information



Made in Germany

All details given in our sales brochures and catalogues, as well as the information available online, are based on our current knowledge of the products described. The electronic data and files made available by Murrplastik, particularly CAD files are based on our current knowledge of the product described. A legally binding assurance of certain properties or the suitability for a certain purpose can not be determined from this information. All information with respect to the chemical and physical properties of Murrplastik products, as well as application advice given verbally, in writing or by tests, is given to the best of our knowledge. They do not release the buyer from the obligation to carry out his own tests and trials in order to determine the concrete suitability of the products for the intended purpose. Murrplastik accepts no responsibility for the available information being up-to-date, correct or complete. Neither do we accept responsibility for the quality of this information. Murrplastik accepts no liability for damage caused as a result of using our products. Murrplastik reserves the right to make technical changes and improvements through constant further development of products and services. Our General Terms and Conditions apply.